

### Log Set Assembly

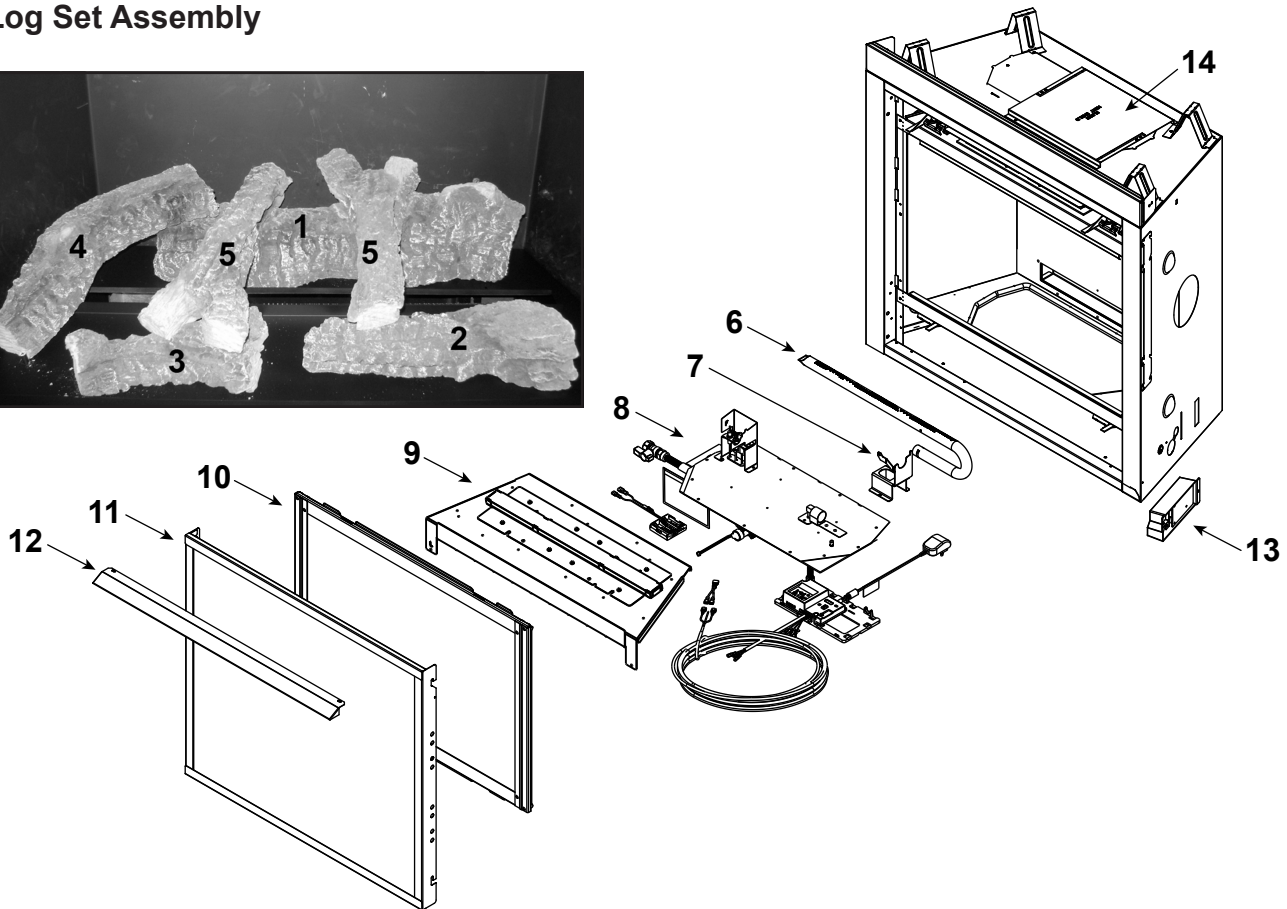

IMPORTANT: THIS IS DATED INFORMATION. Parts must be ordered from a dealer or distributor.

**Hearth and Home Technologies does not sell directly to consumers.** Provide model number and serial number when requesting service parts from your dealer or distributor.

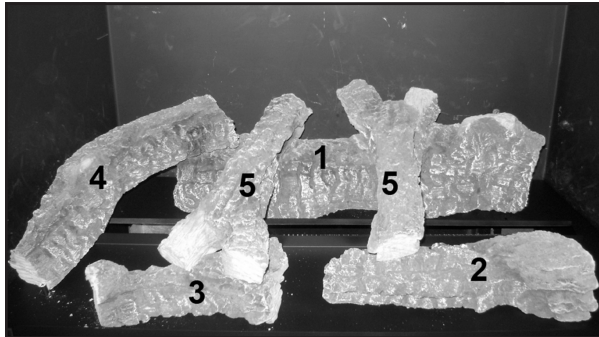

**Stocked  
at Depot**

ITEM	DESCRIPTION	COMMENTS	PART NUMBER	
	Log Set Assembly		LOGS-550F	Y
1	Log 1		SRV2297-700	
2	Log 2		SRV2033-709	
3	Log 3		SRV2033-708	
4	Log 4		SRV2033-721	
5	Log 5	Qty 2 req	SRV2033-720	
6	Burner NG, LP		2297-105	Y
7	Burner Leg		2297-103	
8	Valve Assembly		See following page	
9	Base Pan		2297-017	
10	Glass Door Assembly		GLA-550TR	Y
11	Firescreen Front		FS-5-BK	
12	Hood		2115-230	
13	Junction Box		SRV4021-013	Y
14	Elbow Heat Shield		385-290	

Additional service part numbers appear on following page.

### #8 Valve Assembly

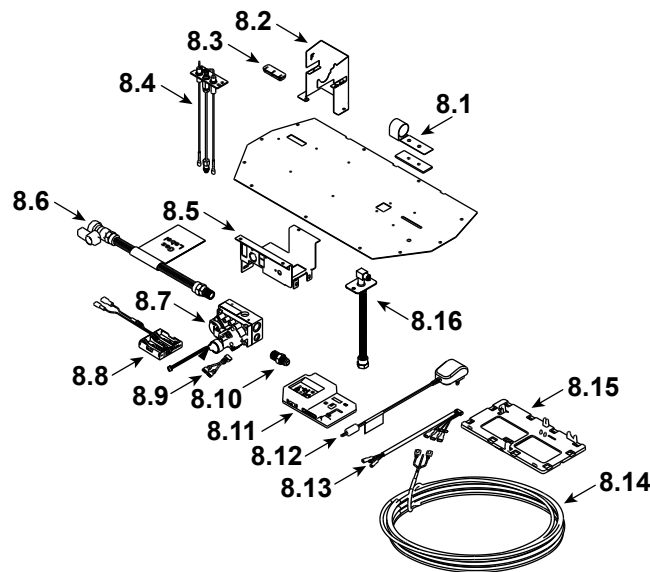

IMPORTANT: THIS IS DATED INFORMATION. Parts must be ordered from a dealer or distributor. **Hearth and Home Technologies does not sell directly to consumers.** Provide model number and serial number when requesting service parts from your dealer or distributor.



**Stocked  
at Depot**

ITEM	DESCRIPTION	COMMENTS	PART NUMBER	
8.1	Shutter Bracket Assembly		2118-121	Y
8.2	Pilot Bracket		2297-112	
8.3	3-Hole Grommet		SRV2118-420	
8.4	Pilot Assembly NG		SRV2090-012	Y
	Pilot Assembly LP		2090-013	Y
	Pilot Tube		SRV485-301	Y
8.5	Valve Bracket		2118-104	
8.6	Flex Ball Valve Assembly		SRV302-320	Y
8.7	Valve NG		SRV2166-302	Y
	Valve LP		2166-303	Y
8.8	Battery Pack **		SRV2326-134	Y
8.9	Jumper Wire		SRV2187-198	Y
8.10	Male Connector	Pkg of 5	303-315/5	Y
8.11	Module, IFT Control		SRV2326-130	Y
8.12	6 Volt Transformer		SRV2326-131	Y
8.13	Wire Harness, IFT 6 Pin		SRV2326-132	Y
8.14	Thermostat Wire Assembly		SRV2118-170	Y
8.15	Component Tray		2279-185	
8.16	Bulkhead w/Flex Tube		SRV7000-156	Y
	Orifice NG (#45)		SRV582-845	Y
	Orifice LP (1.25 mm)		582-8125	Y

\*\*Fuse for battery pack can be sourced locally, not a warranty item. Specs are 250v, 3A fuse, 3/4" long

Additional service part numbers appear on following page.



## Service Parts

# SL-5F-IFT

## No one builds a better fire

**Beginning Manufacturing Date: March 2020**  
**Ending Manufacturing Date: Active**

**IMPORTANT: THIS IS DATED INFORMATION.** Parts must be ordered from a dealer or distributor. **Hearth and Home Technologies does not sell directly to consumers.** Provide model number and serial number when requesting service parts from your dealer or distributor.



### Stocked at Depot

ITEM	DESCRIPTION	COMMENTS	PART NUMBER	
	Drywall Support		2391-119	
	Exhaust Baffle		550-155	
	Exhaust Restrictor		530-299	
	Gasket Assembly Contains Burner neck, shutter bracket, vent, seal cap, valve plate, and air passage gaskets		2115-080	
	Glass Latch Assembly	Pkg of 2	2382-400/2	Y
	Heat Shield, Junction Box		2372-127	
	Heat Shield, Header		2118-120	
	Lava Rock		4021-297	
	Rock Placement Jig		2297-113	
	Touch Up Paint		TUP-GBK-12	
	Valve Plate Cover		2188-101	
	Shoulder Bolt	Pkg of 25	319-835-25	
	Conversion Kit NG		NGK-SL-IFT	Y
	Conversion Kit LP		LPK-SL-IFT	Y
	Pilot Orifice NG		SRV593-528	Y
	Pilot Orifice LP		SRV593-527	Y
	Regulator NG		NGK-DXV-50	Y
	Regulator LP		SRVLPK-DXV-50	Y